



Rederij DRIEMAST B.V.

Handelskade 4
3434 BA Nieuwegein
Tel: +31 (0)30-6018558
KvK nr: Utrecht 30213324
BTW nr: 815932455B01

Mobiel: Henk +31 (0)6-23 609 666
Mobiel: Jan Marten +31 (0)6-53 921 144
Fax: +31 (0)30-6018560
E-mail: info@rederij-driemast.nl
www.rederij-driemast.nl

slb "MEANDER"

Technical Specifications



ahts "MEANDER"

General

Yard : Gebr. Kooiman B.V. / Zwijndrecht / 2006
Gross Tonnage : 239
Nett Tonnage : 71
Crew : 5 persons
Accommodation : 8 persons, fully air-conditioned
Classification : L.R.S. 100A1 TUG – Unrestricted Service
Flag : Dutch
Owners : Rederij Driemast B.V. / Handelskade 4 / 3434 BA / Nieuwegein /
The Netherlands

Dimensions

Length Overall : 29.80 m
Beam : 9.50 m
Depth (moulded) : 3.10 m
Draught : 2.50 m

Tank capacities

Fuel : 108 m³ (Diesel)
Lubrication Oil : 10.3 m³
Freshwater : 35 m³
Sewage : 12.5 m³ (Sewage can also be taken from other vessels)
Dirty Oil : 5.1 m³

Performances

Bollard Pull : 30.3 tons

Propulsion system

Main Engines : Mitsubishi 2x 940 kW (1278 hp) each
Bow thruster : Veth / 165 kW

Auxiliary Equipment

Generator sets : 1x 392 kVa Mitsubishi (335 kW / 455 hp)
: 2x 65 kVa John Deere
Fuel Transfer pump : 25 m³/hrs @ 15 mtr height
Freshwater Transfer pump : 25 m³/hrs @ 15 mtr height
Lubrication Oil Transfer pump : 2 m³/hrs
Dirty Oil Transfer pump : 2 m³/hrs
Fuel Separator : 2x Alfa-Laval 5000 ltr/24 hrs
Freshwater Maker : 3500 ltr / 24 hrs

Deck Lay-out

Free deck space 100 m² / 3x 20ft container fitted / Reefer plug available / 1x 125 Amp, 2x 32 Amp. /
Pedestal for people transfer on fore deck

Heila crane type HLRM 200 mt – 4 SL max 9.5 tons @ 15.75 mtr / local and remote controlled

Towing/Pushing Equipment : Hydraulic Towing Winch; Pulling force of approx. 22 ton.
Holding force 60 tons
2 Drums; One with 700 mtr of Ø 38 mm steel wire and
one with 400 mtr of Ø 38 mm steel wire
Stern roller / Hydraulic Towing Pins and wire catcher in aft deck swl
30 ton
Pushing i.c.w. towing winch and wire-drum on anchor winch
Rubber fender push bow

Nautical and Communication Equipment

Consoles	: 1x Front navigation console with clear forward view : 1x Aft navigation console with clear view over the work deck, crane and towing winch Wheelhouse fully air-conditioned
Radar	: 1x JRC-type JMA-5310-6 (with ARPA functionality) in front navigation console : 1x JRC-type JMA-609-7 (River Radar) with 2 colour screens, one in the front and one in the aft navigation console
AIS	: 1x Simrad AI80 AIS transmitter/receiver
Gyro Compass	: 1x Alphanon-type Minicourse and steering repeater in front Navigation console
Automatic pilot	: 1x Anschütz-type NP 60 (Sea Pilot) in front navigation console : 1x Alphanon-type Alphapilot MC (River Pilot). Remote unit in aft navigation console
Rudder Angle Indicator System	: 1x Alphanon-type Alphanon MC. Slave in aft navigation console and steering room
Rate of Turn Indicator System	: 1x Alphanon-type Alphanon MC in front navigation console
Magnetic Compass	: Cassens & Plath with analogue repeater in front navigation console
Echo Sounder	: JRC-type JFE-582 Graphic recorder fitted near chart table and remote display unit in front navigation console
DGPS	: SAAB-type R4 DGPS fitted near chart table
Camera System	: 4x Camera, 2 on each side of the vessel to reduce the dead angle 1x 15" TFT monitor / Quad presentation in front navigation console
Intercom	: Alphanon-type Alphacall (with 5 call stations) in front navigation console Remote unit in aft navigation console
VHF	: 2x Sailor-type RT 5022 25 Watt + DSC in front navigation console. 2x remote unit in aft navigation console and 1x remote unit in mess room 2x Handheld watertight GMDSS VHF transceivers McMurdo-type R2 2x Handheld watertight VHF transceivers ICOM-type IC33
MF/HF	: 1x Sailor-type System 4000 150 Watt PEP + DSC in front console
Inmarsat-C	: 2x Sailor-type TT3000E on radio desk
Navtex	: 1x JRC-type NCR-333 fitted near chart table
IridiumSatellite telephone	: 1x Iridium Pilot system for voice and data on radio desk
GSM	: 1x GSM telephone on radio desk with extra call point in mess room
Electronic NavChart System	: 1x Simrad CS68ECDIS with 24" screen in front and aft navigation console (Jeppesen ENC charts)
Weather	: 1x Wind measuring syst. Alphanon-type Alphawind in front console
Administration a.o.	: 1x PC on radio desk
Survey	: Survey Desk with cable pipe through wheelhouse wall Survey equipment can be mounted i.c.w. a bracket on the forehead or side of the vessel

For further information you can contact us through above mentioned contact details.

Tugboat "Meander"

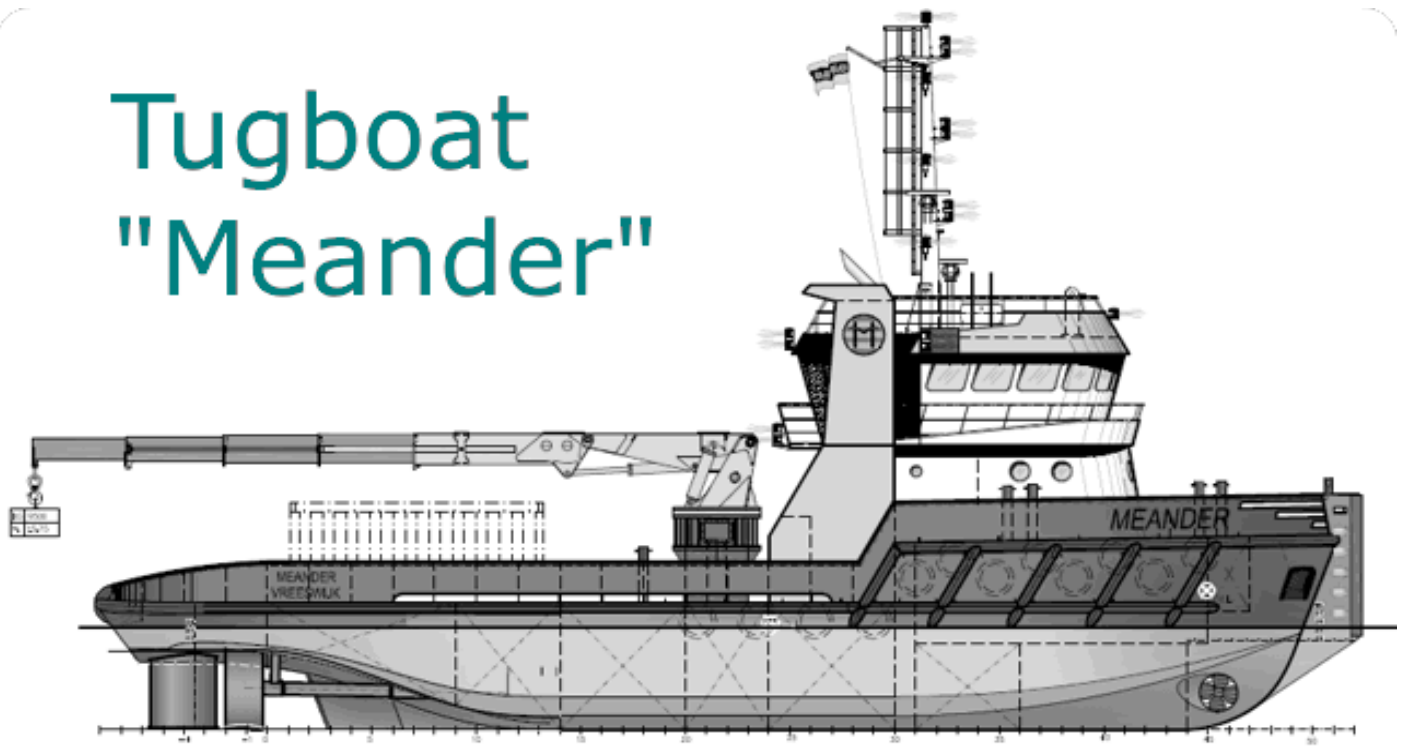

MAIN DECK/TWEEN DECK

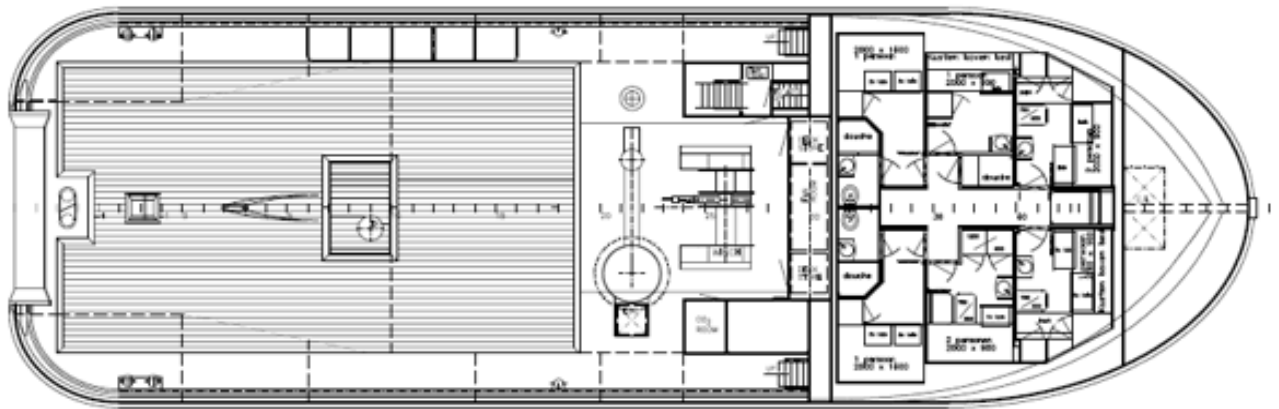

TANKTOP

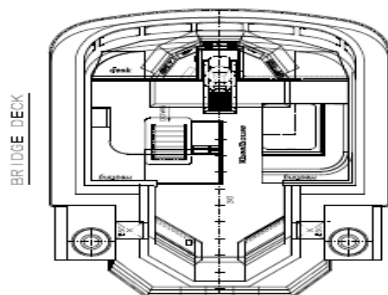
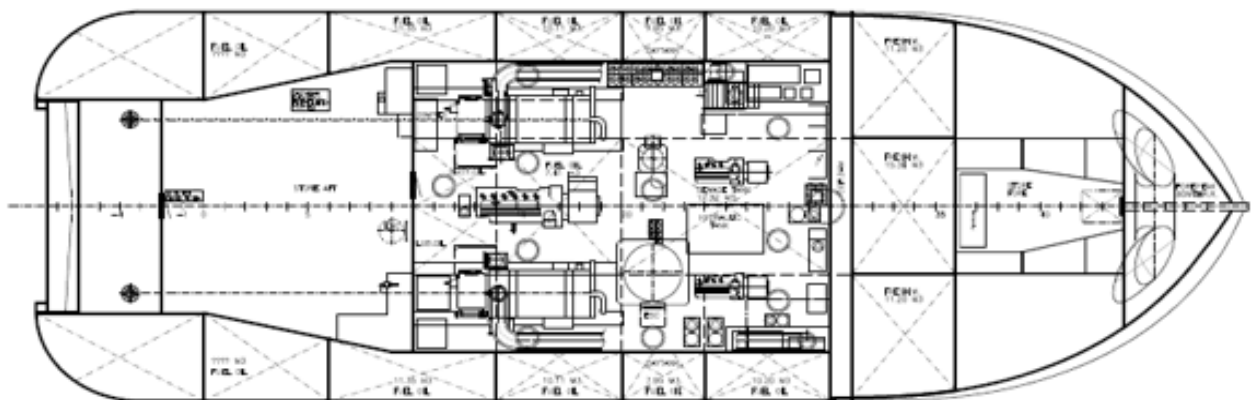

BRIDGE DECK

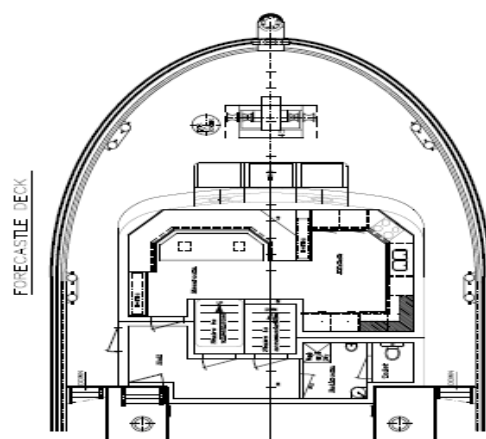

FORECASTLE DECK